

How to use the Figures Tool

The Figures Tool is one of the digitizing capture modes available in Sierra software. This tool shortens the process in creating basic shapes such as circles, squares, rectangles, triangles and others as outlined below. The Figures function is used with the Path Tool, Simple Area Tool and Complex Area Tool, utilizing the stitch types available with each tool. Select the tool desired first, then click the Figures icon and click the shape needed for the section you wish to create. A simple click and drag motion will add the figure to your project.

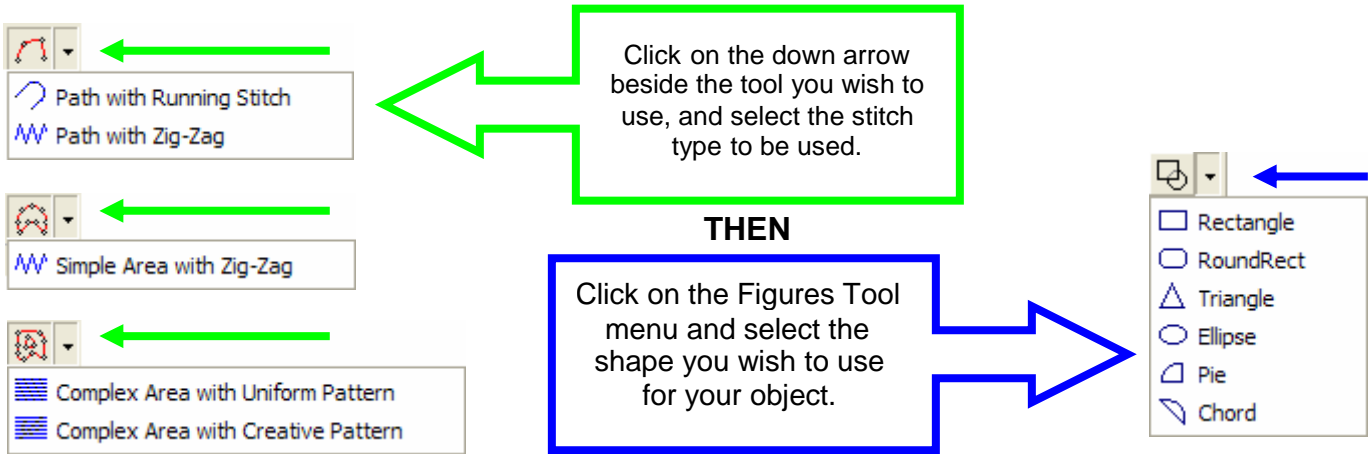

Let's start with the Path Tool with Zig Zag stitch to see how the basic principal of using the Figures Tool works. In this exercise, we will create a simple circle utilizing the Ellipse Figures shape. Follow the numbered instructions to create the object then generate stitches.

1 **CLICK! DRAG! DRAW!**

2 **Let Go of Mouse Button!**

3 **Hit Enter to generate stitches**

4 **To edit the object, click the Edit Section Icon.**

Then click the object.

Click the Object Inspector icon if needed to make changes to properties of the created object.

Object Inspector: Path	
Object Inspector	
Size & Order	
Main	
Fill Mode	Zig-Zag
Color	2
Density	5.00 lines/mm
Spacing	0.20 mm
Column Width	25 pts
Path Layout	50 %
Z Stitches	No
Adjustment & Compensation	
Stitch Effects	
Connections & Functions	

Now we will use the Complex Area Tool with Uniform Pattern to create the next object. Let's use the Round Rectangle in which the curvature of the corners can be adjusted to suit your desired shape. Such curvature can range from a sharp angle to a very open curve (close to being an oval, without sharp ends). Just like the previous exercise, we will repeat the process below to create the Round Rectangle and illustrate the feature.

2 Click and drag the slider to the right to give all edges a greater curve. Drag the slider to the left to make all edges more pointed.

3 Hit Enter to fill with stitches.

4 Click the Edit Section icon then the object. Click Object Inspector icon to access the Properties box. Make changes as needed to suit your digitized object.

1 Click and drag to draw the object size.

Object Inspector	
Size & Order >>	
Main ▾	
Fill Mode	Uniform Pattern
Color	3
Name	up-40-02-00-40-00
Density	4.50 lines/mm
Spacing	0.22 mm
Edge Bordering	No
Hole	Empty
Adjustment & Compensation >>	
Stitch Effects >>	
Connections & Functions >>	
Outline >>	

- NOTES:**
- The Object Inspector (or Properties) works in the same way for an object created with the Figures Tool as it does for an object created freehand.
 - When editing such object, you will notice that there are sufficient nodes to move or adjust, which you do in the same way as if those nodes had been manually digitized.
 - Entry and Exit points are automatically added and can be adjusted after stitch generation.

The illustration below shows how you can add your own Direction line to your digitized shapes.



Click and drag to draw shape size.

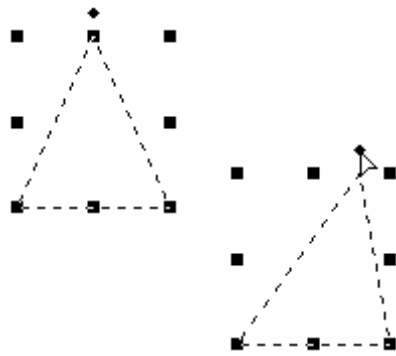

Once the shape is drawn, click and drag the slider in either direction to adjust the shape of your object.



Right click on the screen and select Direction from the drop down menu.

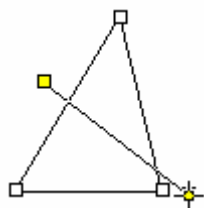

After selecting Direction Line from the drop down menu, left click where you want the Direction Line to start, then drag to create the angle you wish, and finally click once again to anchor it.



Hit Enter or click the Generate button to fill in with stitches.

DID YOU KNOW?

After tracing an AutoShape, and before generating stitches, you can also:

- click and drag the nodes while holding down the **SHIFT** key to resize the shape
- press the **CTRL** key while clicking and dragging corner nodes to rotate the shape
- simply click inside the shape and drag it to a new place to move it where needed

SIERRA SAYS...

The Figures Tool makes creating simple objects quick and easy, allowing more time to be used on the complex objects of the design. While this function provides a different way to create an object, it does NOT change the section editing process that usually follows, making for a very user-friendly addition.